

ASSEMBLY-DD6601-LANDING GEAR SYSTEM

| FIGURE N° | PART NUMBER | NOMENCLATURE / DESCRIPTION | QUANTITY PER SET | MEASURE UNIT |
|-----------|-------------|---|------------------|--------------|
| 1 | MFR01 | 14-inch main landing gear right wheel | 1 | PC |
| 2 | MFR02 | Right supporting shaft of main landing gear | 1 | PC |
| 3 | MFL01 | 14-inch main landing gear left wheel | 1 | PC |
| 4 | MFL02 | Left supporting shaft of main landing gear | 1 | PC |
| 5 | MF53 | Main landing gear axle fixation plate | 2 | PC |
| 6 | MJ01 | Brake disc | 2 | PC |
| 7 | MF52 | Axle nut | 2 | PC |
| 8 | NR01 | 11-inch nose landing gear wheel | 1 | PC |
| 9 | NF59 | Nose wheel axle | 1 | PC |
| 10 | NF24 | Nose gear wheel fork | 1 | PC |
| 11 | NG01 | Nose gear universal joint | 1 | PC |
| 12 | NF25 | Turning stop block | 1 | PC |
| 13 | NF45 | Centre-return limit shaft | 1 | PC |
| 14 | NF19 | Nose gear main supporting arm | 2 | PC |
| 15 | NF20 | Support block for main supporting arm | 1 | PC |

ASSEMBLY-DD6601-LANDING GEAR SYSTEM

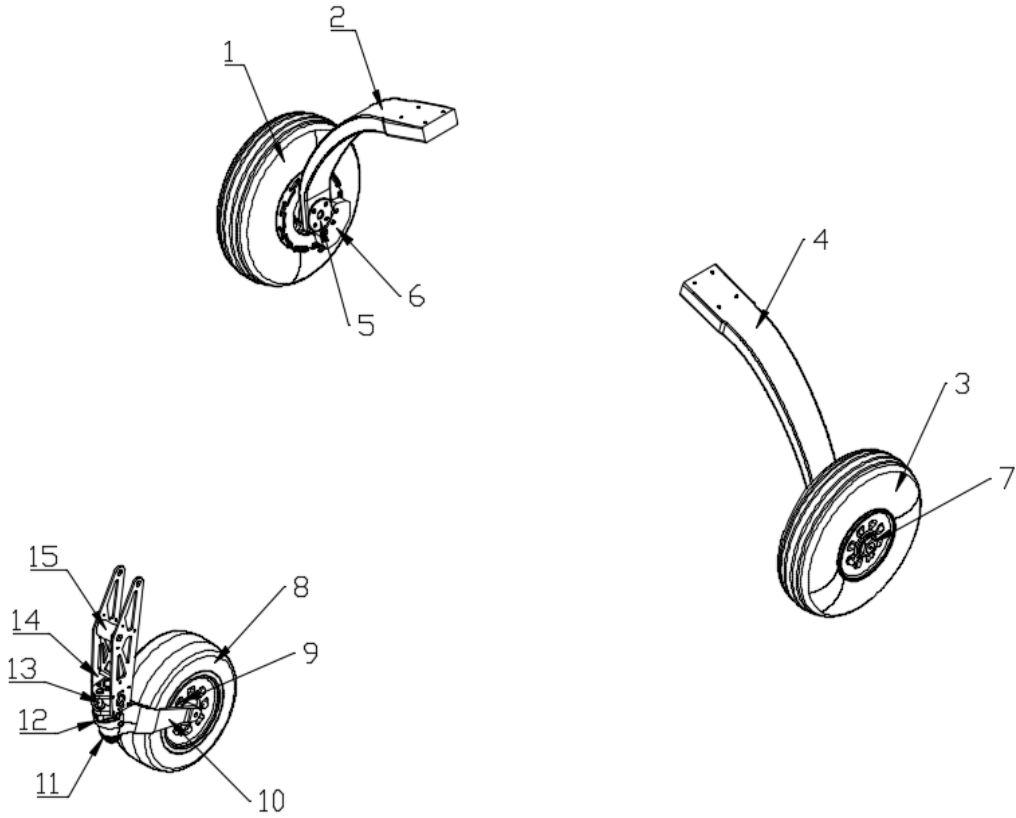

ALPHA NUMERIC PARTS LIST

| PART NUMBER | ASSEMBLY | PAGE N° | FIGURE N° |
|-------------|-----------------|---------|-----------|
| MFR01 | ASSEMBLY-DD6601 | 1 | 1 |
| MFR02 | ASSEMBLY-DD6601 | 1 | 2 |
| MFL01 | ASSEMBLY-DD6601 | 1 | 3 |
| MFL02 | ASSEMBLY-DD6601 | 1 | 4 |
| MF53 | ASSEMBLY-DD6601 | 1 | 5 |
| MJ01 | ASSEMBLY-DD6601 | 1 | 6 |
| MF52 | ASSEMBLY-DD6601 | 1 | 7 |
| NR01 | ASSEMBLY-DD6601 | 1 | 8 |
| NF59 | ASSEMBLY-DD6601 | 1 | 9 |
| NF24 | ASSEMBLY-DD6601 | 1 | 10 |
| NG01 | ASSEMBLY-DD6601 | 1 | 11 |
| NF25 | ASSEMBLY-DD6601 | 1 | 12 |
| NF45 | ASSEMBLY-DD6601 | 1 | 13 |
| NF19 | ASSEMBLY-DD6601 | 1 | 14 |
| NF20 | ASSEMBLY-DD6601 | 1 | 15 |